

GLENWOOD SPRINGS MALL

51027 Highway 6 & Highway 24, Glenwood Springs, CO



PROPERTY OVERVIEW:

- Inline, pad, and box space available
- Excellent visibility and access from I-70
- Regional hub that draws from several nearby counties



For more information:

Mike DePalma

720 598 6043

mdepalma@creginc.com



GLENWOOD SPRINGS MALL

51027 Highway 6 & Highway 24, Glenwood Springs, CO

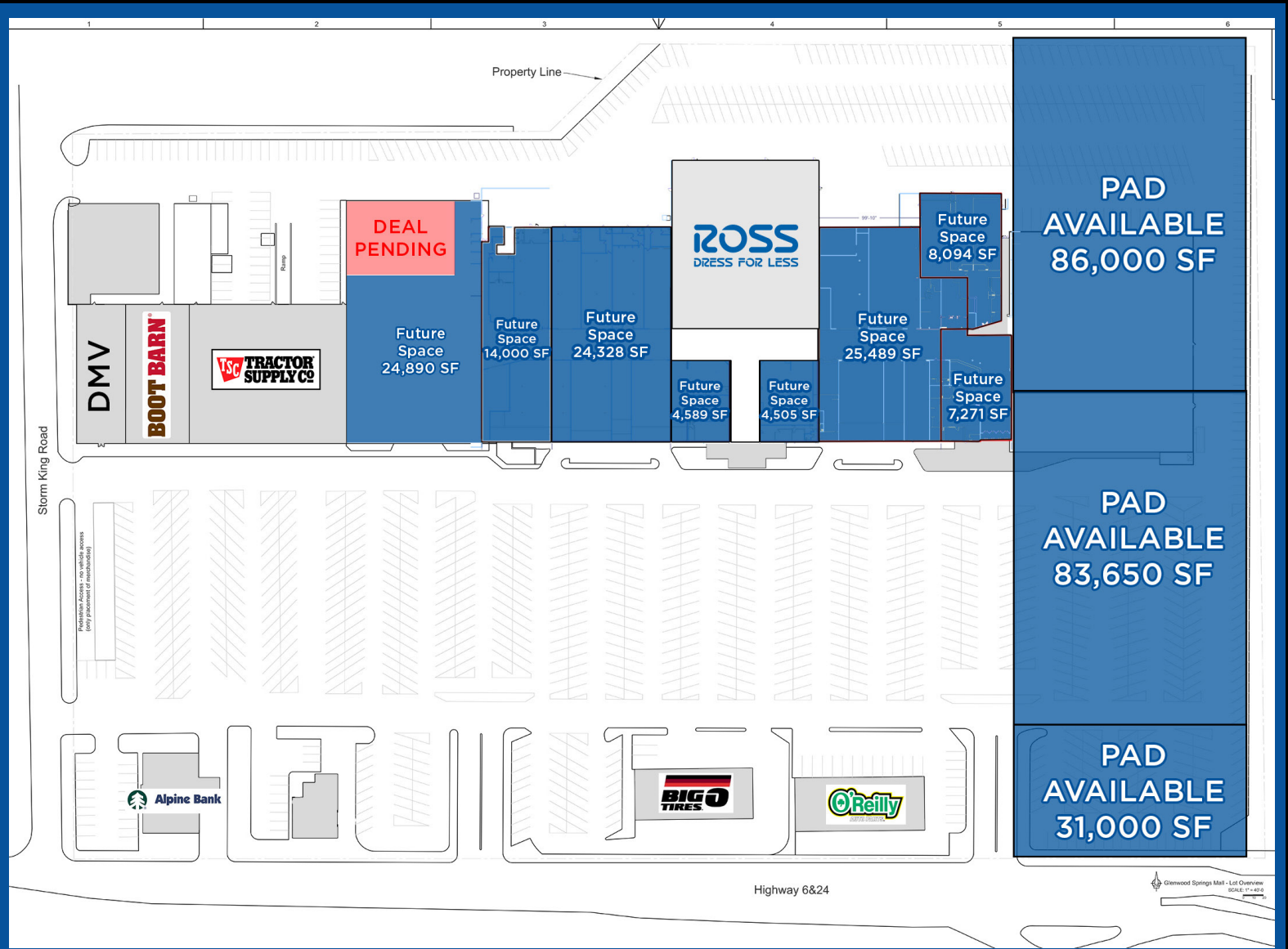

SEEKING THE FOLLOWING USES:

- Hotel/Hospitality
- Restaurant - F&B
- Grocery
- Liquor
- Furniture
- Home Supply - flooring/tile
- Appliance
- Ski/Bike
- Pickle Ball
- and more!



[click to watch video](#)

For more information:

Mike DePalma

720 598 6043

mdepalma@creginc.com



GLENWOOD SPRINGS MALL

51027 Highway 6 & Highway 24, Glenwood Springs, CO



Glenwood Springs attracts more than **1.3 million** visitors per year

Mike DePalma 720-598-6043 mdepalma@creginc.com



GLENWOOD SPRINGS MALL

51027 Highway 6 & Highway 24, Glenwood Springs, CO



Mike DePalma
720-598-6043
mdepalma@creginc.com

SITE



The information contained in this brochure was compiled from reliable sources, however, Crosbie Real Estate Group, LLC does not warrant nor guarantee the accuracy of the representations herein. Crosbie Real Estate Group, LLC and its broker associates, as listed, are representing the Landlord/Seller of this property. Different brokerage relationships exist.

→ **Gypsum**
Pop: 6,367
Eagle
Pop: 5,878

← **New Castle**
Pop: 4,124
Silt
Pop: 2,993
Rifle
Pop: 10,122



GLENWOOD SPRINGS HOT SPRINGS
560,000+ yearly visitors

DEMOGRAPHICS

POPULATION

	5 Mile:	10 Mile:	45 Mile:
	11,981	22,736	125,472

AVG. HH INCOME

	5 Mile:	10 Mile:	45 Mile:
	\$113,708	\$122,521	\$144,125

HOUSEHOLDS

	5 Mile:	10 Mile:	45 Mile:
	4,668	8,773	48,744

AVG. DAILY TRAFFIC

	On I-70 at Highway Exit	27,000 VPD
	On Highway 6 at Site	8,736 VPD
	On Midland Ave south of Site	12,588 VPD

DAYTIME POPULATION

	5 Mile:	10 Mile:	45 Mile:
	9,954	12,477	48,046

GLENWOOD SPRINGS HIGH SCHOOL
1,002 Students



↙ **Carbondale**
Pop: 6,937
Basalt
Pop: 3,586

↘ **45 Minutes to Aspen**